

## Panel Plug Receptacle—Slotted Contact

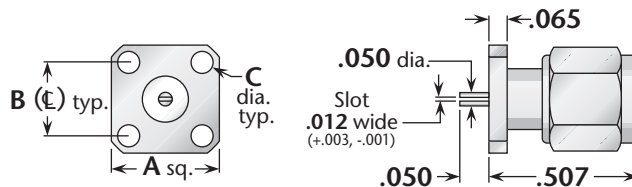

**Figure 1**  
(3/8" square flange)

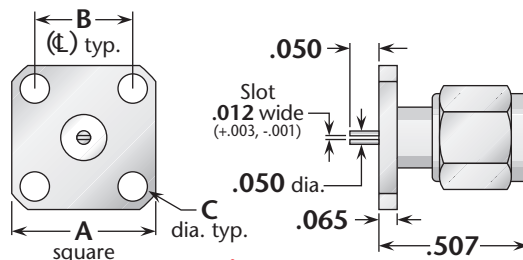

**Figure 2**  
(1/2" square flange)

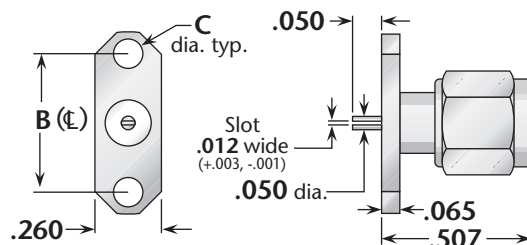

**Figure 3**  
(2-hole flange)

### Other Standard Slot Widths

Our other standard slot widths for these connectors (.018" and .036") are readily available—call for part numbers.

Figure	Dimensions			Mounting Figure	Plating		Delta P/N
	A	B	C		Body	Contact	
1	.375	.250	.067	91	Gold	Gold	1359-000-G910-4
1	.375	.250	.067	91	Passivated	Gold	1359-000-K910-4
1	.375	.250	.067	91	Gold	Gold (C)	1359-000-G911-23
1	.375	.250	.067	91	Passivated	Gold (C)	1359-000-K911-23
2	.500	.340	.102	05	Gold	Gold	1359-000-G050-7
2	.500	.340	.102	05	Passivated	Gold	1359-000-K050-7
2	.500	.340	.102	05	Gold	Gold (C)	1359-000-G051-38
2	.500	.340	.102	05	Passivated	Gold (C)	1359-000-K051-38
3	.625	.481	.102	92A	Gold	Gold	1359-000-G920-2
3	.625	.481	.102	92A	Passivated	Gold	1359-000-K920-2
3	.625	.481	.102	92A	Gold	Gold (C)	1359-000-G921-20
3	.625	.481	.102	92A	Passivated	Gold (C)	1359-000-K921-20

See page 203 for mounting dimensions. • (C) in contact plating column indicates captive contact (epoxy captivated).  
All items available with other flange, contact, and insulator configurations.